

NOTE:

- * When running in very dusty conditions, oil changes should be performed more frequently than specified in the maintenance schedule.
- * Please dispose of used engine oil in a manner that is compatible with the environment. We suggest you take it in a sealed container to your local recycling center or service station for reclamation. Do not throw it in the rubbish or pour it on the ground.

CAUTION:

- * **Used engine oil may cause skin cancer if repeatedly left in contact with the skin for prolonged periods. Although this is unlikely unless you handle used oil on a daily basis, it is still advisable to thoroughly wash your hands with soap and water as soon as possible after handling used oil.**

CRANKCASE BREATHER

(Refer to the maintenance precautions on page 50).

1. Remove the drain plug (1) from the tube and drain deposits into a suitable container.
2. Reinstall the drain plug.

NOTE:

- * Service more frequently when riding in rain or at full throttle.

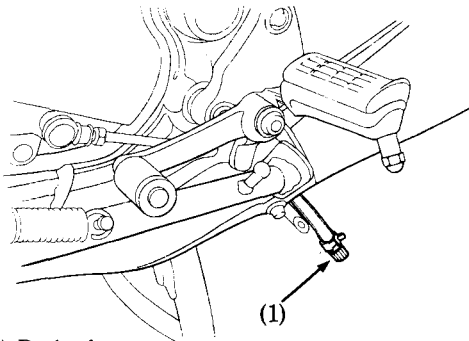

(1) Drain plug